

DESCRIPTION

The TOA Wireless Tuner Module WTU-4800 is a PLL-synthesizer controlled double superheterodyne diversity tuner module designed to be used in conjunction with UHF wireless equipment. It employs a compressor-expander system noise reduction circuit to minimize the influence of ambient RF noise.

SPECIFICATIONS

(*1) 0 dB = 1 V

| | |
|-------------------------|----------------------------------------------------------------------------------|
| Power Requirement | 7 - 12 V DC |
| Current Consumption | 100 mA |
| Receiving Frequency | 576 - 865 MHz (*2), UHF |
| Receiving System | Double super-heterodyne |
| Receiving Sensitivity | 80 dB or more, Signal to Noise Ratio (20 dB μ V input, 40 kHz deviation) |
| Antenna Input Impedance | 75 Ω |
| Diversity System | Space diversity |
| Channel Selectable | 16 channels |
| Squelch System | Noise SQ |
| Squelch Sensitivity | 17 dB μ V |
| Output | 0 dB (*1) (maximum deviation, 2.2 k Ω load) |
| Harmonic Distortion | 1% or less |
| Frequency Response | 100 Hz - 12 kHz, \pm 3 dB |
| Operating Temperature | -10 $^{\circ}$ C to +50 $^{\circ}$ C (14 $^{\circ}$ F to 122 $^{\circ}$ F) |
| Operating Humidity | 30 % to 85 %RH (no condensation) |
| Finish | Surface-treated steel plate |
| Dimensions | 60 (W) \times 25 (H) \times 139 (D) mm (2.36" \times 0.98" \times 5.47") |
| Weight | 130 g (0.29 lb) |
| Accessory | Driver for channel changing.....1 |

APPEARANCE

Rear View

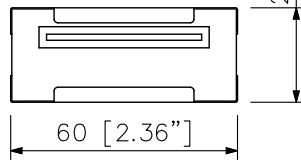

Top View

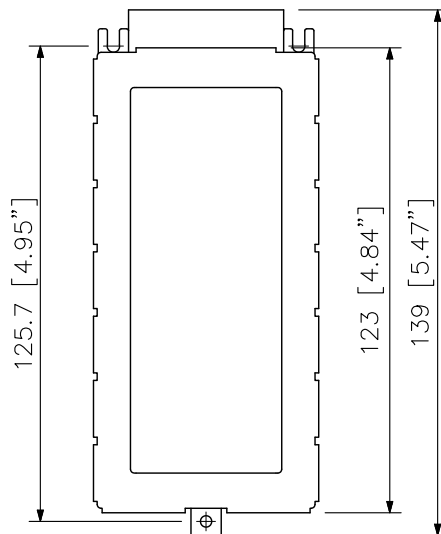

Front View

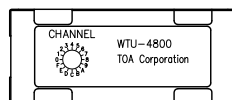

Side View

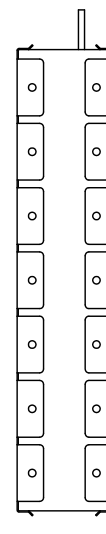

(*2)

| Type | Receiving Frequency |
|-----------|---------------------|
| A01 | 692 - 722 MHz, UHF |
| B01, B02 | 722 - 752 MHz, UHF |
| C01 - C07 | 794 - 830 MHz, UHF |
| D01 - D05 | 830 - 865 MHz, UHF |
| E01 | 668 - 698 MHz, UHF |
| F01 | 636 - 666 MHz, UHF |
| G01, G02 | 606 - 636 MHz, UHF |
| H01 | 576 - 606 MHz, UHF |

UNIT: mm SCALE: 1/2